

R SHIFTER KNOB



P/N 2884792

BEFORE YOU BEGIN

Read these instructions and check to be sure all parts and tools are accounted for. Please retain these installation instructions for future reference and parts ordering information.

APPLICATION

Verify accessory fitment at www.polarisslingshot.com.

KIT CONTENTS

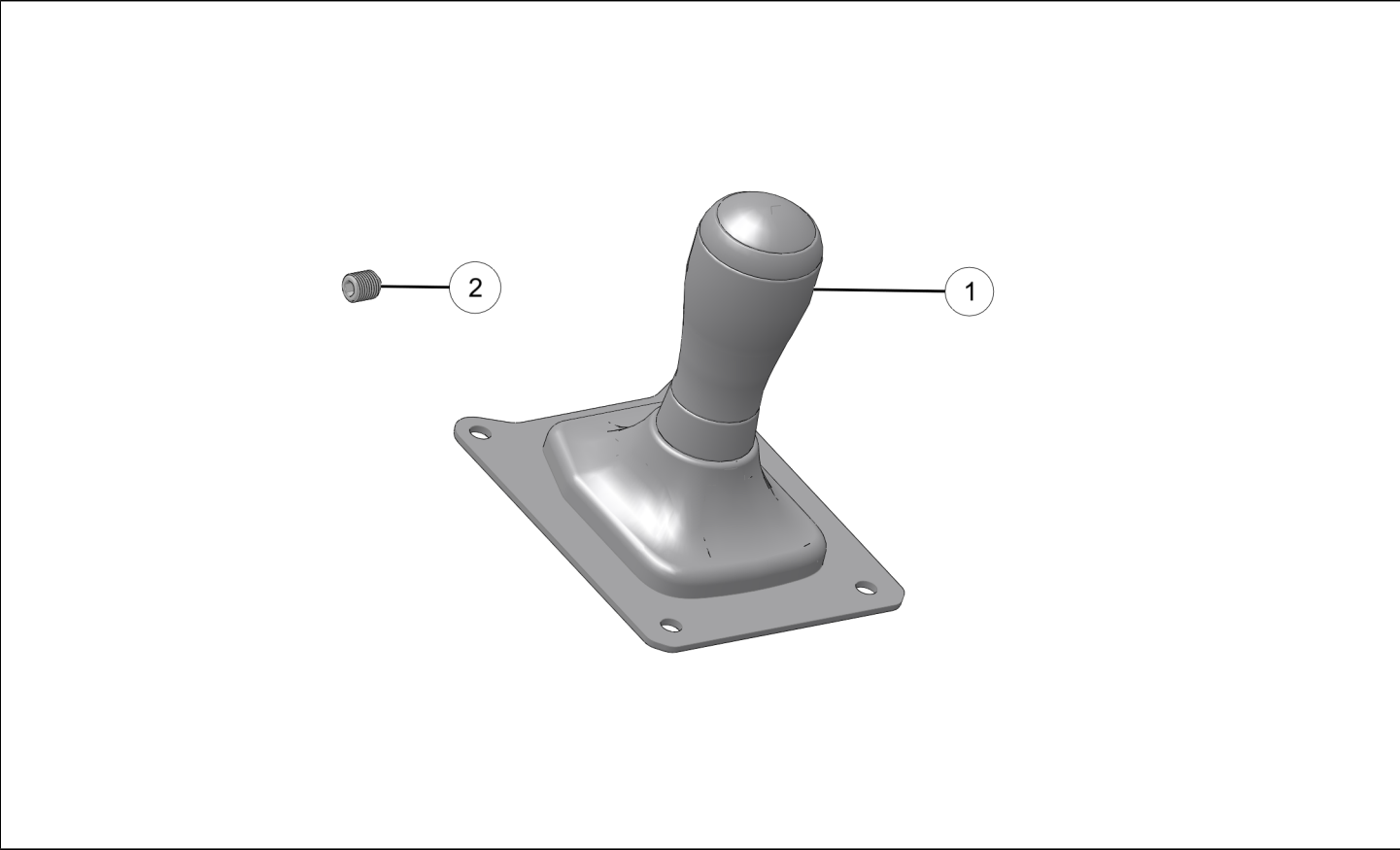

REF	QTY	PART DESCRIPTION	P/N AVAILABLE SEPARATELY
1	1	Assembly-Shift Knob, R	2010485
2	1	Set Screw – M10 x 1.0 x 12 mm	7520131

TOOLS REQUIRED

- Safety Glasses
- Pliers, Push Pin Rivet
- Pry Tool
- Socket Set, Hex Bit, Metric
- Torque Wrench

IMPORTANT

Your R Shifter Knob is exclusively designed for your vehicle. Please read the installation instructions thoroughly before beginning. Installation is easier if the vehicle is clean and free of debris. For your safety, and to ensure a satisfactory installation, perform all installation steps correctly in the sequence shown.

INSTALLATION INSTRUCTIONS

VEHICLE PREPARATION

GENERAL

1. Park vehicle on a flat surface.
2. Shift vehicle to NEUTRAL.
3. Press START/STOP button to turn vehicle OFF.
4. Apply parking brake.
5. Remove key fob from proximity of vehicle.

REMOVE CENTER CONSOLE TRIM

1. Remove and keep two push pin rivets ①.

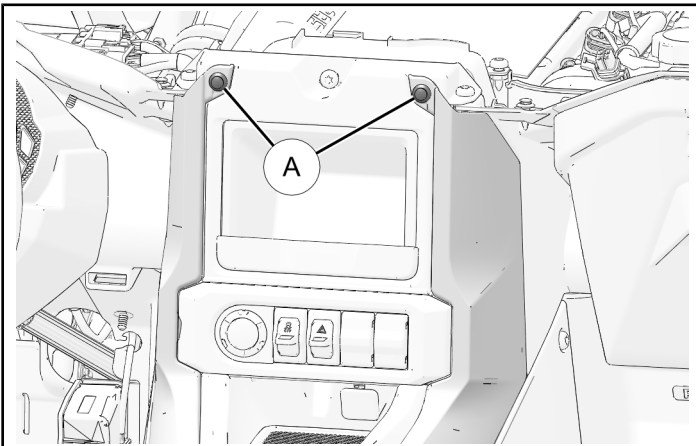

2. Lift up and pull to rear to remove center console trim. Carefully set aside.

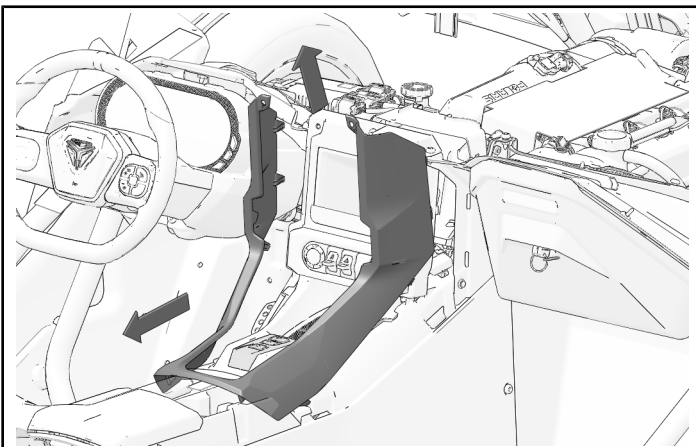

MANUAL SHIFTER REMOVAL

1. Lift front end of rear storage bin assembly near shifter base to detach clips. It is not necessary to remove the entire assembly.

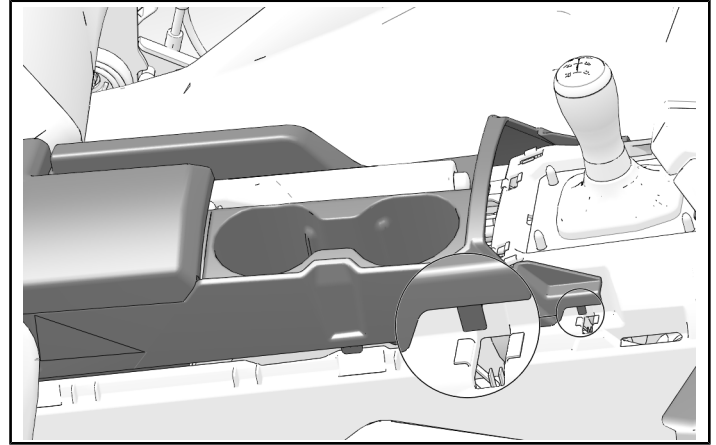

2. Lift end of tray assembly near shifter base to detach clips. Lift and move rearward to remove from vehicle.

NOTICE

If equipped, remove USB power supply plug and mounting grommet from storage tray.

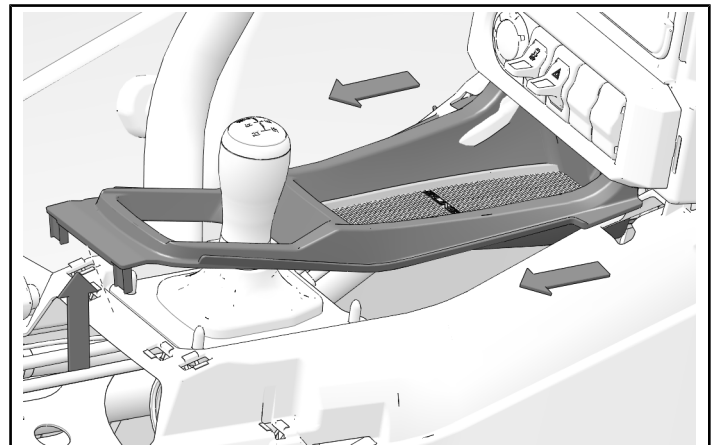

- Detach four clips located under the shifter to remove shift boot.

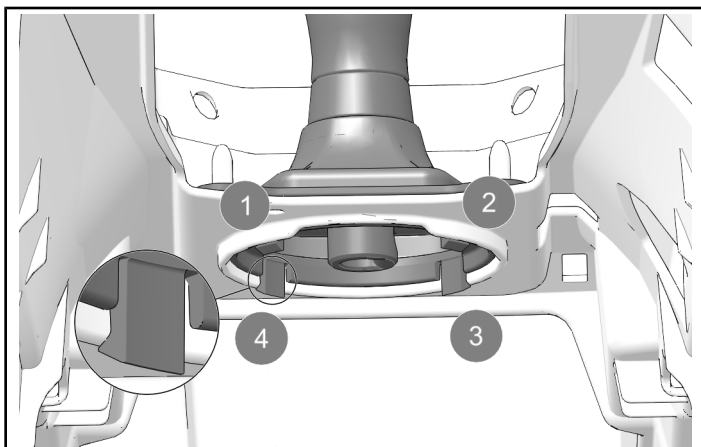

- Lift shifter boot and remove set screw (B). Remove shifter assembly from vehicle.

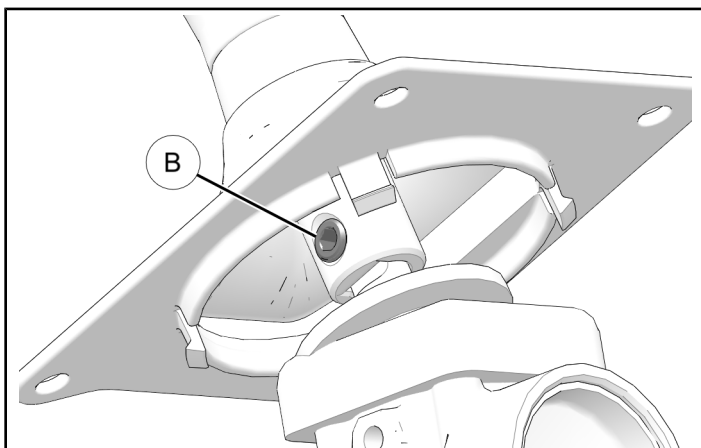

ACCESSORY INSTALLATION

- Put shifter (1) in position. Make sure transmission shift rod is inserted in shifter.

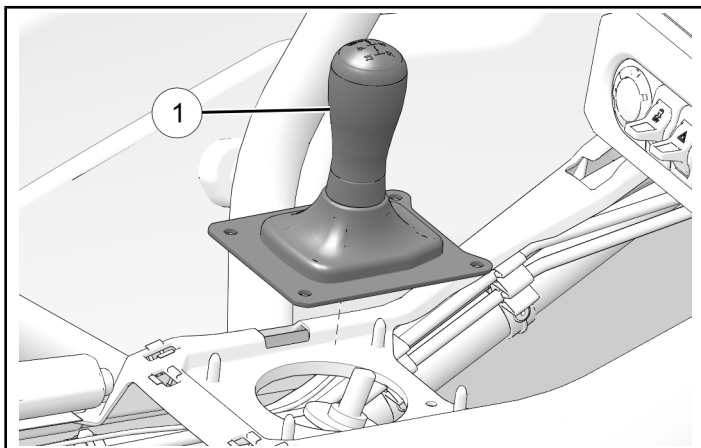

- Install set screw (2). Torque screw to specification.

TORQUE

Shifter set screw (2):
22 ft-lbs (30 N·m)

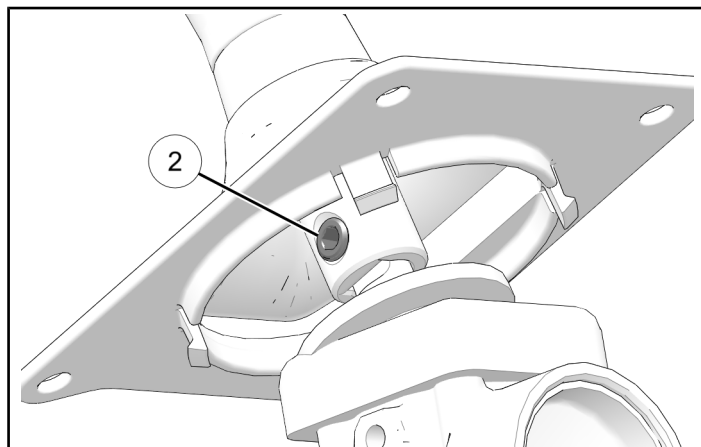

- Attach four clips located under the shifter to install shift boot.

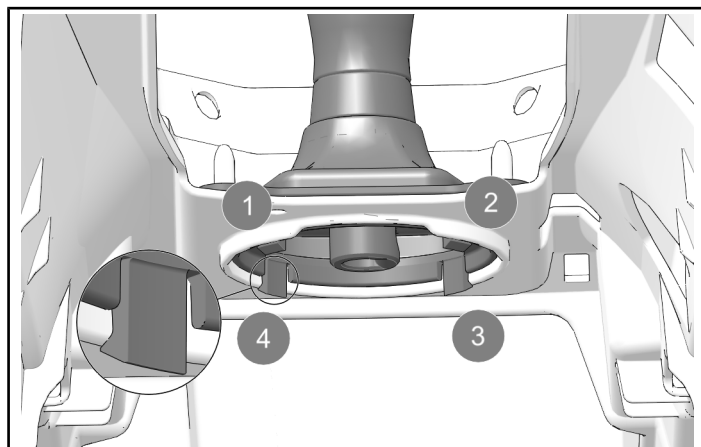

VEHICLE REASSEMBLY

CENTER CONSOLE STORAGE

- Put center storage tray in place. Slide front tabs in place, then snap rear clips into mounting holes.

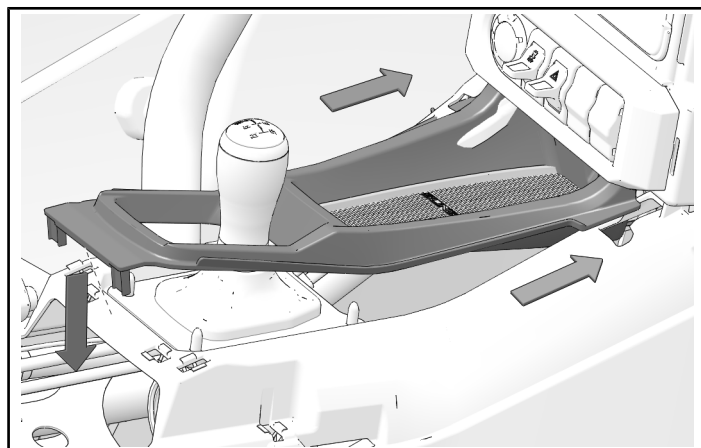

2. Tilt rear storage bin down and snap into mounts.

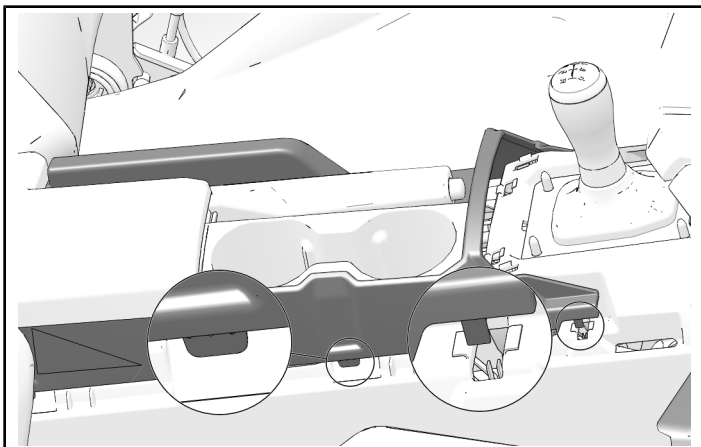

2. Attach center console trim with two retained push pin rivets (A).

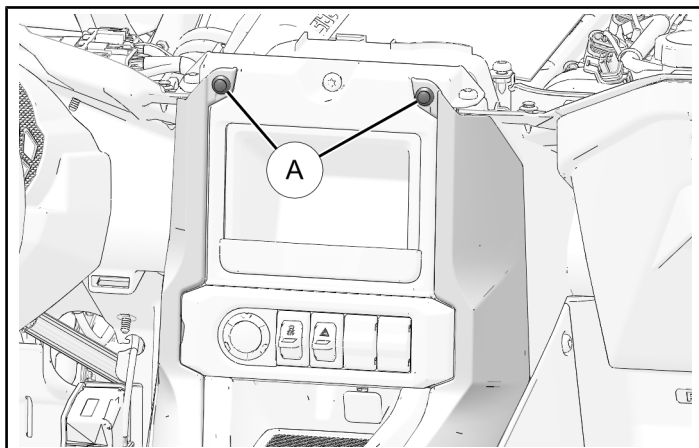

INSTALL CENTER CONSOLE TRIM

1. Install center console trim onto console. Make sure tabs are installed into openings.

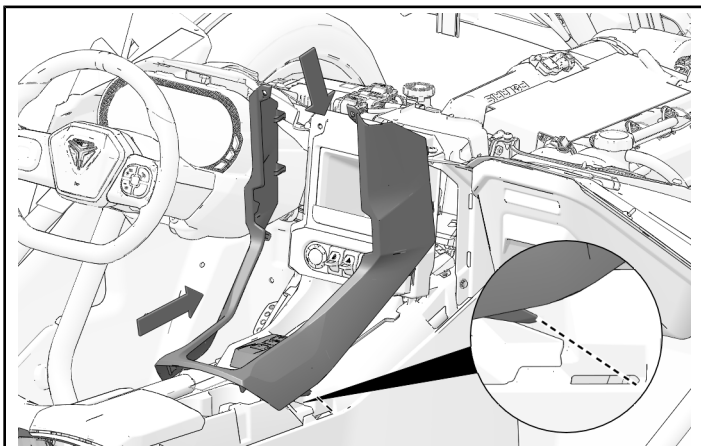

INSTRUCTION FEEDBACK FORM

A feedback form has been created for the installer to provide any comments, questions or concerns about the installation instructions. The form is viewable on mobile devices by scanning the QR code or by clicking [HERE](#) if viewing on a PC.

