

PERFORMANCE PEDALS KIT



SLINGSHOT

P/N 2882334, 2884790

APPLICATION

Verify accessory fitment at www.polarisslingshot.com.

BEFORE YOU BEGIN

Read these instructions and check to be sure all parts and tools are accounted for. Please retain these installation instructions for future reference and parts ordering information.

DISCLAIMER ACCESSORY WEIGHT

When adding accessories, equipment, passengers and luggage to your vehicle, do not exceed the total weight capacity of the vehicle or of the front or rear axle (GVWR or GAWR as indicated on the Safety Compliance Certification label). Ask an authorized dealer for specific weight information if you need assistance. It is the owner's responsibility to use the Polaris Slingshot Accessories website as a tool for limiting the amount of accessories, based on maximum allowable vehicle weight requirements. It may be a violation of the Clean Air Act or the NHTSA regulations to disregard these requirements. For a complete listing of the accessories that are available for your vehicle, please contact your authorized dealer or visit the online store web site: Web Address (United States): <http://www.polaris.com/en-us/slingshot/shop/accessories>.

KIT CONTENTS

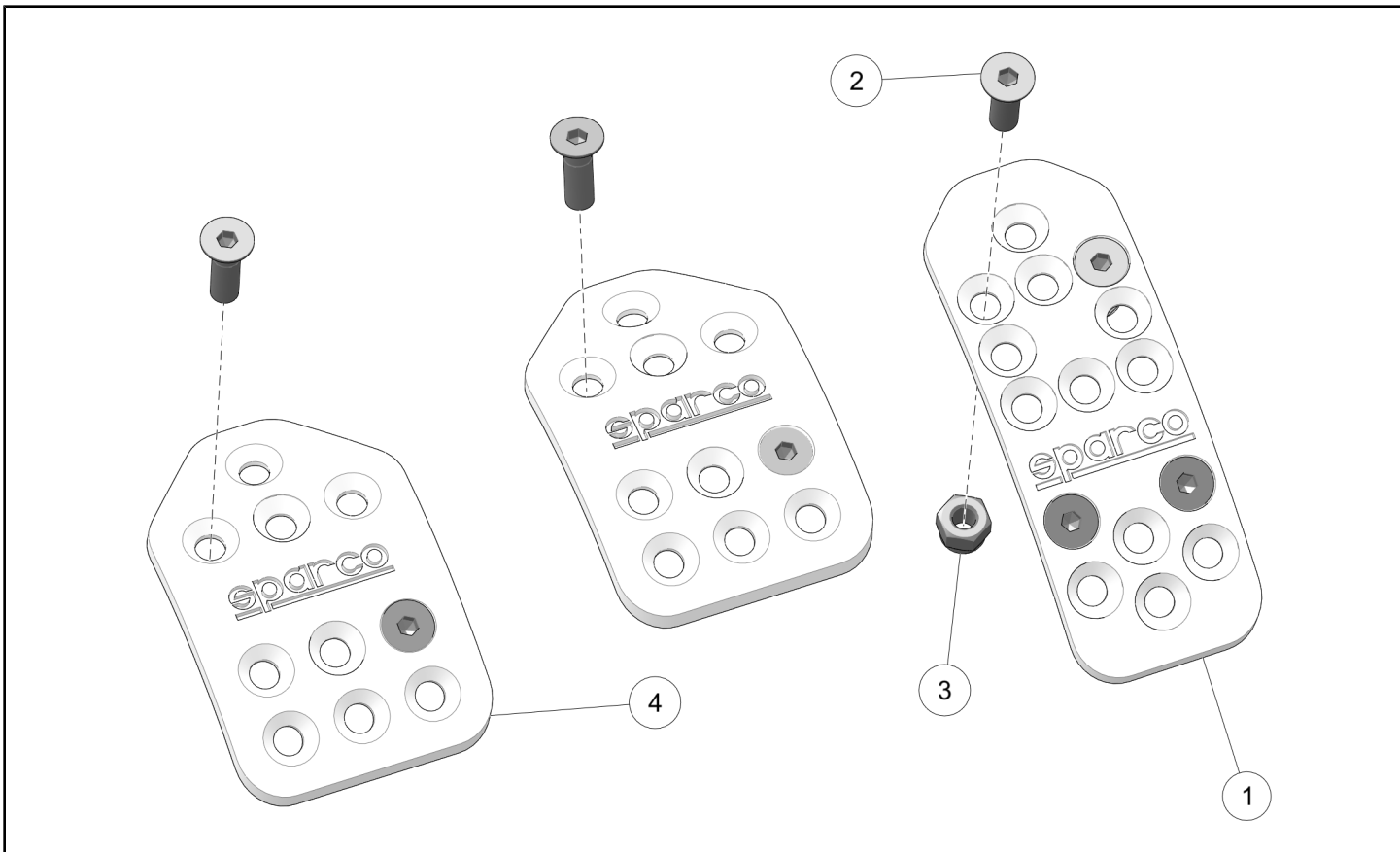

PERFORMANCE PEDALS KIT, P/N 2882334

| REF | QTY | PART DESCRIPTION | P/N AVAILABLE SEPARATELY |
|-----|-----|--------------------------|--------------------------|
| 1 | 1 | Throttle Pedal Cover | 5262628 |
| 2 | 8 | Screw, M6 - 20 10.9 | 7520516 |
| 3 | 4 | Lock Nut, M6 - 4 | 7547833 |
| 4 | 2 | Clutch/Brake Pedal Cover | 5262626 |

PERFORMANCE PEDALS KIT, P/N 2884790

| REF | QTY | PART DESCRIPTION | P/N AVAILABLE SEPARATELY |
|-----|-----|--------------------------|--------------------------|
| 1 | 1 | Throttle Pedal Cover | 5262628 |
| 2 | 6 | Screw, M6 - 20 10.9 | 7520516 |
| 3 | 4 | Lock Nut, M6 - 4 | 7547833 |
| 4 | 1 | Clutch/Brake Pedal Cover | 5262626 |

TOOLS REQUIRED

- Safety Glasses
- Torque Wrench
- Socket Set, Hex Bit, Metric
- Wrench Set, Metric

IMPORTANT

Your Performance Pedals Kit is exclusively designed for your vehicle. Please read the installation instructions thoroughly before beginning. Installation is easier if the vehicle is clean and free of debris. For your safety, and to ensure a satisfactory installation, perform all installation steps correctly in the sequence shown.

INSTALLATION INSTRUCTIONS

VEHICLE PREPARATION

GENERAL

1. Shift vehicle transmission to **NEUTRAL**.
2. Turn the key to the **OFF** position, if equipped, or press start/stop button to turn vehicle **OFF**.
3. Apply parking brake.
4. Remove key fob from proximity of vehicle.

ACCESSORY INSTALLATION

BRAKE AND CLUTCH PEDAL COVER INSTALLATION

1. Align the brake pedal cover ④ with the brake pedal.

NOTICE

Two of the holes in the brake and clutch pedals are threaded.

2. Install 2 screws ② into the brake pedal. Torque screws to specification.

TORQUE

Brake and Clutch Pedal Screw ②:
24 in-lbs (2.7 N·m)

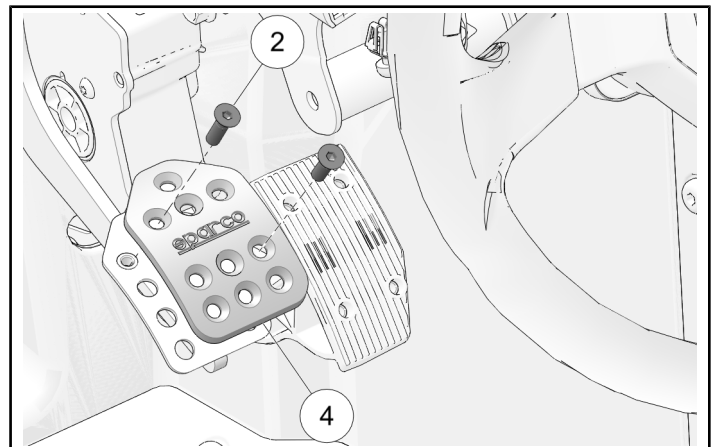

3. Repeat steps 1-2 of this section for the clutch pedal (if equipped).

THROTTLE PEDAL COVER INSTALLATION

1. Align the throttle pedal cover ① with the throttle pedal.

2. Install 4 screws ② and 4 nuts ③ in the throttle pedal. Torque screws to specification.

TORQUE

Throttle Pedal Screw ②:
24 in-lbs (2.7 N·m)

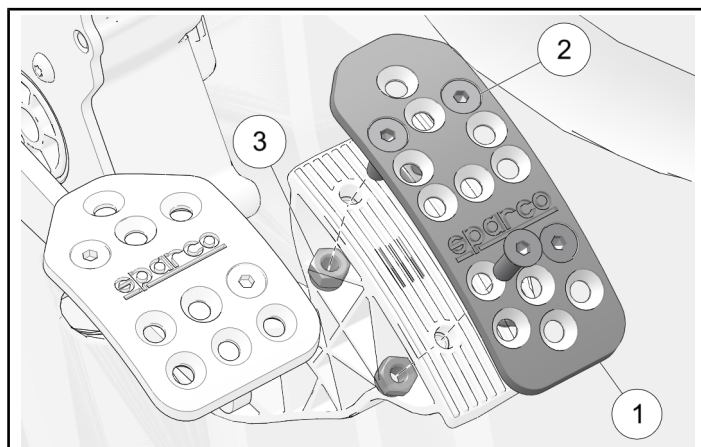

INSTRUCTION FEEDBACK FORM

A feedback form has been created for the installer to provide any comments, questions or concerns about the installation instructions. The form is viewable on mobile devices by scanning the QR code or by clicking [HERE](#) if viewing on a PC.

